

# 3-WAY BATTERY CONNECTOR – RIGHT ANGLE 2 MM PITCH – WITH BOSS

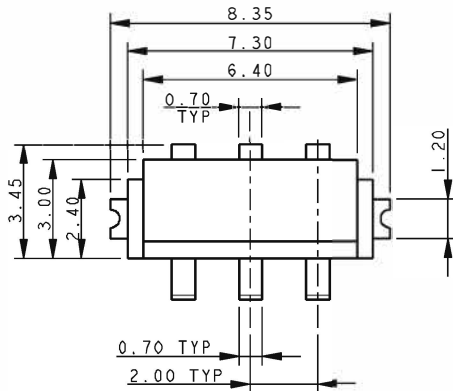

0.05-0.55  
OPERATING NOSE HEIGHT  
SEE ALSO SHEET 14

## DEFLECTED CONTACT

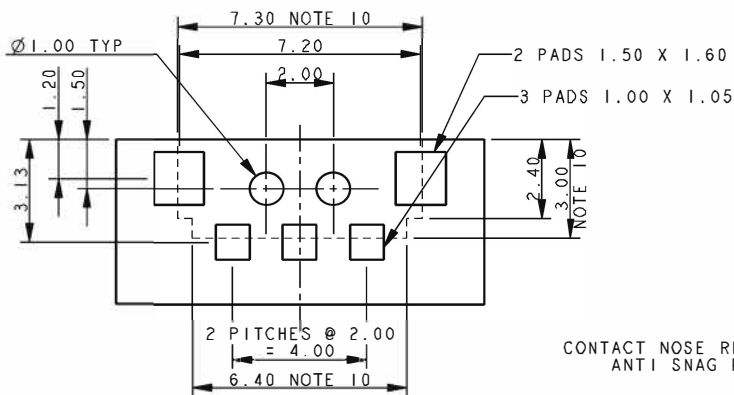
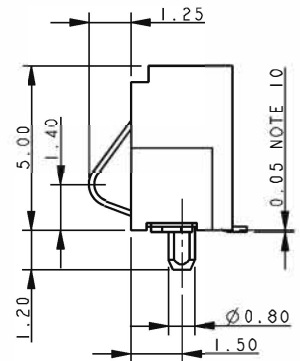
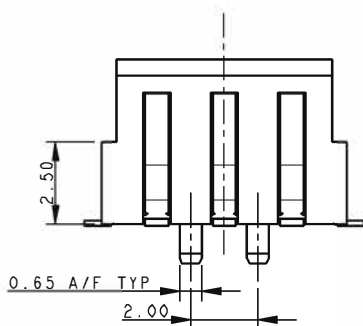

CONTACT NOSE RETAINED  
ANTI SNAG FEATURE

## SUGGESTED PCB LAYOUT

### NOTES:

1. GENERAL TOLERANCE  $\pm 0.20$  UNLESS STATED.
2. FOR FULL PRODUCT DETAILS REFER TO SPECIFICATION 201-01-2014.  
FOR APPLICATION DATA REFER TO SPECIFICATION 201-01-205.
3. FOR MATING PAD DETAILS REFER TO PAGE 44.
4. FOR PACKING DETAILS REFER TO PAGE 43
5. INSULATION MATERIAL: GLASS FILLED NYLON 46, UL94 V-O, COLOR BLACK.
6. CONTACT MATERIAL: BERYLLIUM COPPER.
7. CONTACT PLATING: SELECTIVE GOLD OVER NICKEL, PURE TIN ON TAILS.
8. BRACKET MATERIAL: TIN PLATED PHOSPHOR BRONZE.
9. CONNECTOR OUTLINE.
10. COPLANARITY ON ALL CONTACT TAILS AND PADS 0.12 MM MAXIMUM.